

Ultraminiature Automotive PCB Power Relay **PC537**

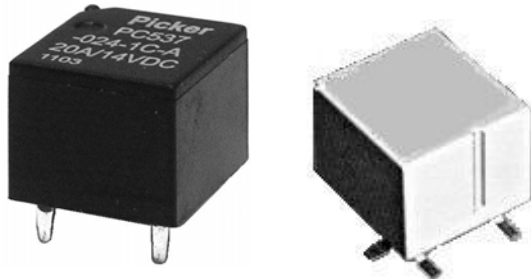

**FEATURES**

- Ultraminiature design very light weight
- Through hole or SMT construction
- Contact switching capacity up to 100 Amps
- Sealed, immersion cleanable
- 105 degrees C operating temperature

**CONTACT RATINGS**

<b>Contact Form</b>	<b>1 Form A or 1 Form C SPST NO or SPDT</b>
<b>Max Switching Current</b>	Make 100 Amps
	Break 30 Amps
<b>Max. Switching Voltage</b>	16 VDC
<b>Max. Continuous Current</b>	NO/30 Amps, NC/25 Amps
<b>Minimum Load</b>	0.5 Amps @ 12 VDC

**CONTACT DATA**

<b>Material</b>	AgNiO 15 (Silver Nickel Oxide 15%) AgSnOInO (Silver Tin Oxide Indium Oxide)	
<b>Initial Contact Resistance</b>	100 milliohms max @ 0.1A, 6VDC	
<b>Service Life</b>	<b>Mechanical</b>	1 X 10 <sup>7</sup> Operations
	<b>Electrical</b>	1 X 10 <sup>5</sup> Operations

**CHARACTERISTICS**

<b>Operate Time</b>	3 ms. typical
<b>Release Time</b>	1.5 ms. typical
<b>Insulation Resistance</b>	100 megohms min, at 500VDC, 50%RH
<b>Dielectric Strength</b>	500 Vrms, 1 min. between coil and contacts
<b>Shock Resistance</b>	30 g, 6 ms, functional; 100 g, destructive
<b>Vibration Resistance</b>	6g, 10 - 500 Hz
<b>Drop Resistance</b>	1 Meter height drop on concrete
<b>Power Consumption</b>	0.55 W
<b>Ambient Temperature Range</b>	-40 to 105 degrees C operating, -40 to 100 storage
<b>Weight</b>	4 grams approx.

**ORDERING INFORMATION**

Example: 

PC537	-1C	-12	S	-N	S
-------	-----	-----	---	----	---

Model			
Contact Form 1A or 1C			
Coil Voltage			
Case Style C: Dust cover; S: Sealed			
Contact Material Nil: AgSnOInO; C: AgCdO; N: AgNi			
Mounting Style Nil: Through Hole, S: SMT			

**COIL DATA**

Coil Voltage	Resistance ohms $\pm$ 10%	Must Operate Voltage Max. (VDC)	Must Release Voltage Min. (VDC)	Continuous Voltage Max. (VDC)
6	64	3.5	0.75	13.6
10	181	5.7	1.25	22.7
12	254	6.9	1.5	27.2
24	1000	14.0	3.0	54.4

**Dimensions in Inches (millimeters)  
Drawings are 2X actual size**

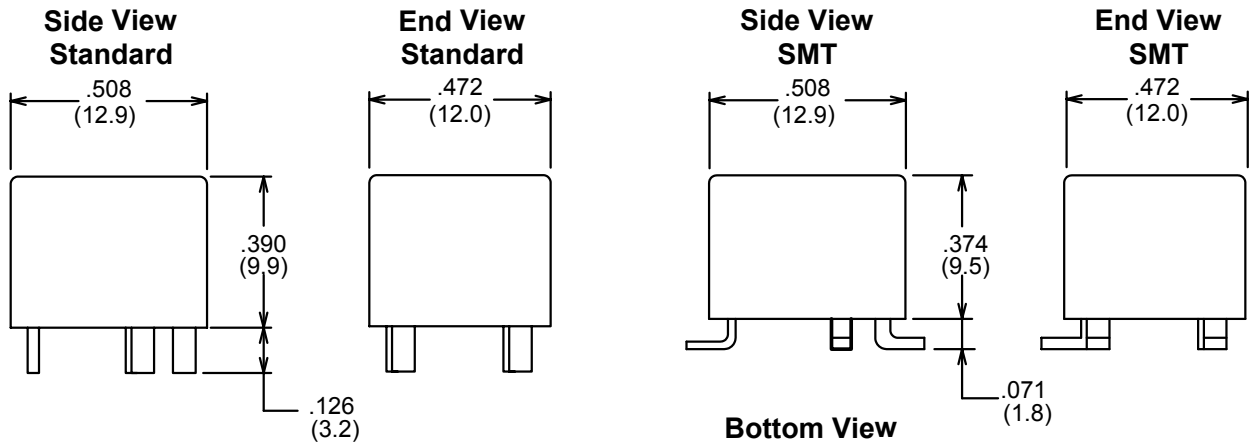

**Bottom View  
PC Board Layout**

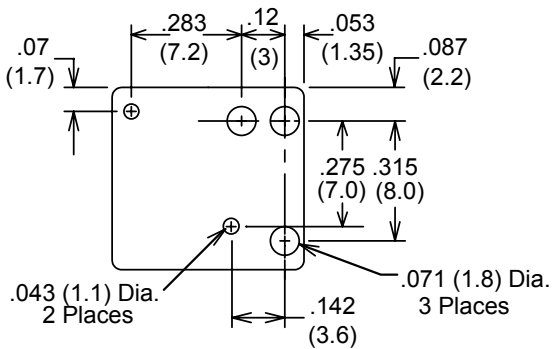

**Bottom View  
Pad Layout**

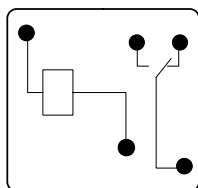
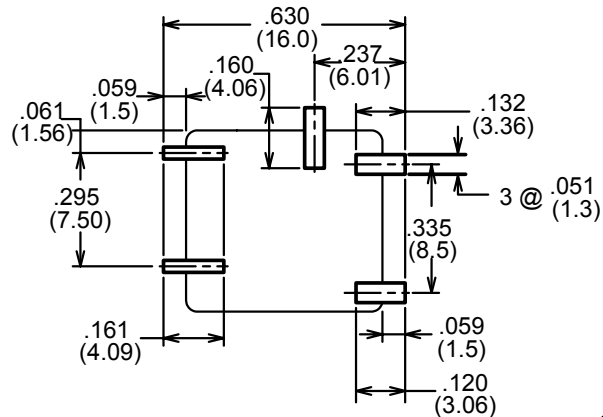

**Bottom View  
Wiring Diagram  
Standard**

Notes:  
Contact Form C shown  
On Contact Form A Unused Pin is Omitted  
Tolerances  $\pm$  .010 unless otherwise noted  
Maximum make current refers to inrush of a lamp load  
In 85 degree C ambient reduce maximum coil voltage to 72%

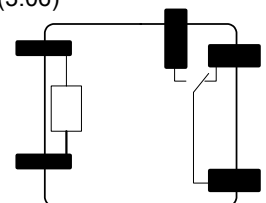

**Bottom View  
Wiring Diagram  
SMT**



3220 Commander Drive, Suite 102, Carrollton, Texas 75006

Sales: Call Toll Free (888) 997-3933 Fax (818) 342-5296 email: pickerwest@sbcglobal.net URL: pickercomponents.com